

Hyatt Regency Milwaukee

DIRECTIONS

From Mitchell International Airport (20 minutes): Travel north to downtown Milwaukee. Take center lane to I-43 North Green Bay system. On I-43 North, take far right lane to the first exit, the Civic Center/ Kilbourn Avenue Tunnel. When reaching the end of the tunnel, continue straight on Kilbourn Avenue. Proceed one long block to hotel, on right.

FIRST FLOOR

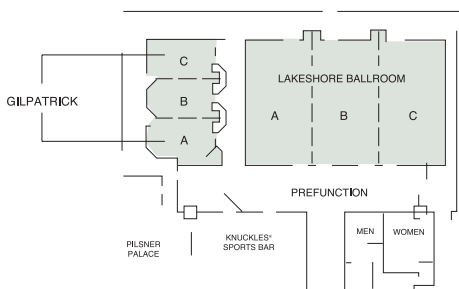

SECOND FLOOR

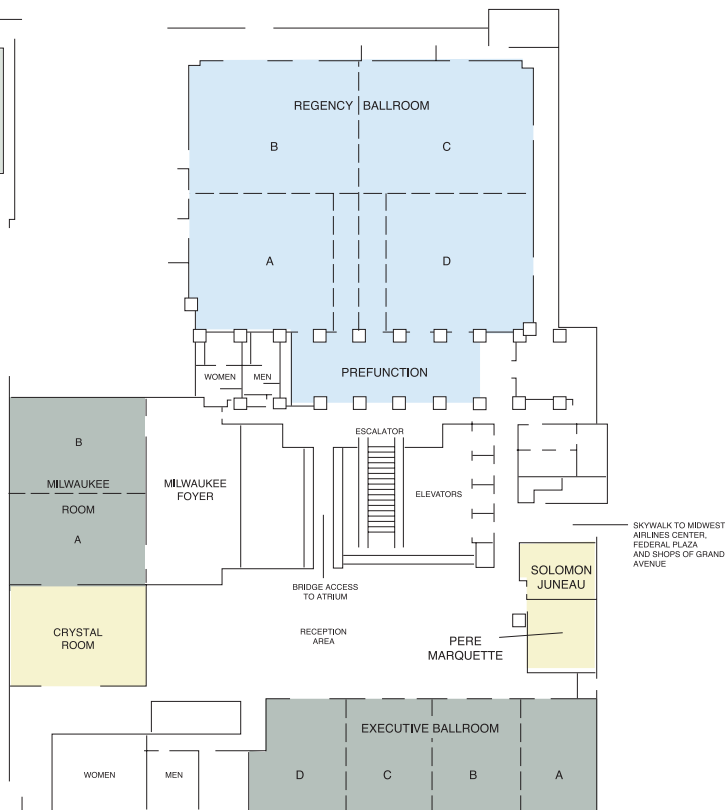

♿ ALL MEETING ROOMS, PHONES AND RESTROOMS ARE WHEELCHAIR ACCESSIBLE, PHONES ARE EQUIPPED FOR HEARING IMPAIRED